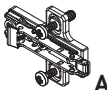
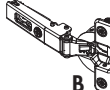
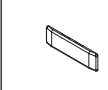
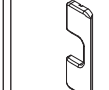
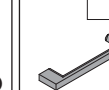
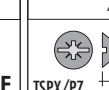
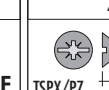
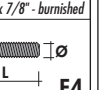
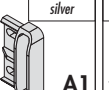
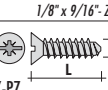

ELITE

SCHEMA DI MONTAGGIO/assembling scheme
 ANTE LEGNO CON CHIUSURA AMMORTIZZATA
 wooden doors with soft-close

LAS

| | |
|--------------------|-------------|
| CODICE code | 777 700 873 |
| DISEGNO drawing | SM 74013 |
| DATA date | 31-07-2019 |
| PAGINA page | 1/2 |

| CODE | COLOUR | CODE | COLOUR | CODE | COLOUR | CODE | COLOUR | CODE | COLOUR | CODE | Ø x L | COLOUR | CODE | COLOUR | CODE | Ø x L | COLOUR | CODE | COLOUR |
|--|---------|---|---------|---|---------|---|---------|---|---------------|---|----------|---|---|-------------------|---|----------|---|-----------|-------------------|
| 507053007 | TITANIO | 507066007 | TITANIO | 507067007 | TITANIO | 507068007 | TITANIO | 508016007 | NERO black | 506910108 | 4MA x 22 | BRUNITA 4MA x 7/8" - burnished | 404400419 | ARGENTO silver | 506940309 | 3,5 x 15 | ZINCATO 1/8" x 9/16" - Zinc Plated | 404400519 | ARGENTO silver |
|  | A |  | B |  | C |  | D |  | E |  | F4 |  |  | A1 |  | B1 |  | C1 | |

**N.B. PER IL MONTAGGIO
SEGUIRE LE FASI NUMERATE**
assemble following the numbered phases

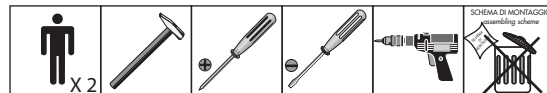

FASI / phases 1-2-3-4-5-6-7

**MONTAGGIO BASSETTE
PER CERNIERE**
 base plates for hinges

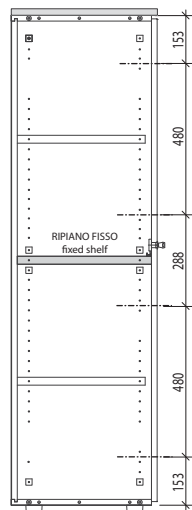
1

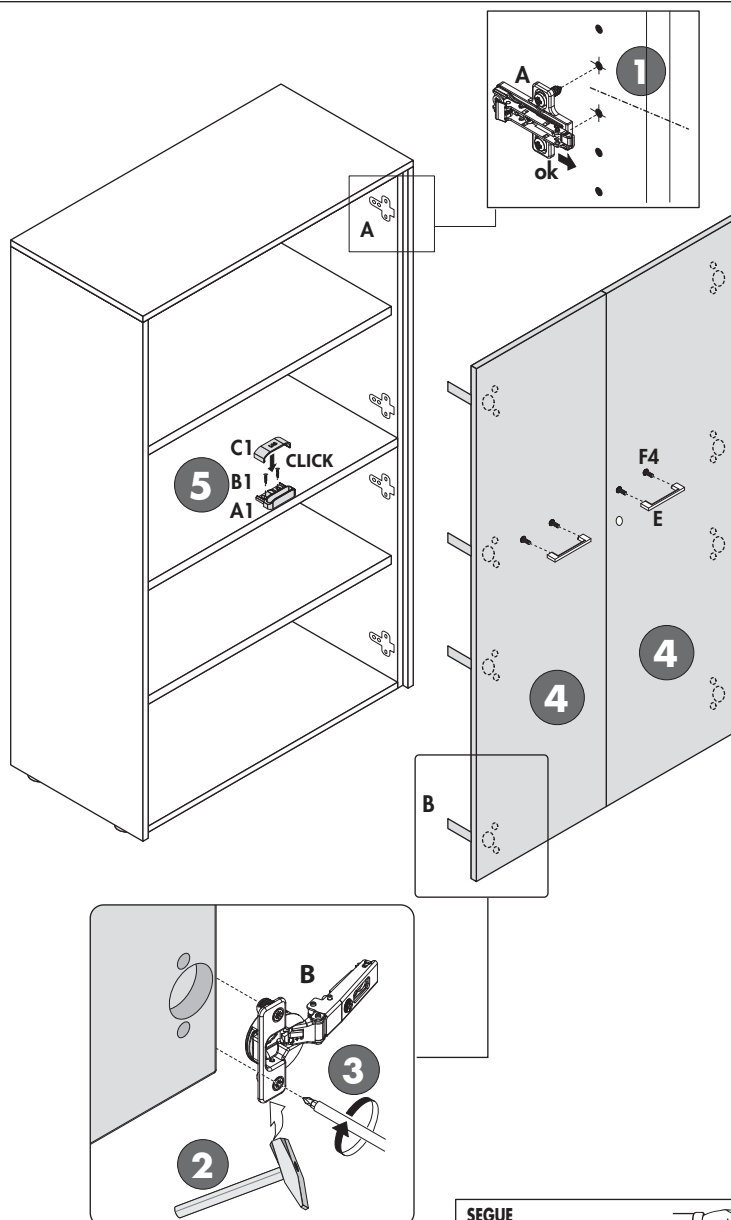
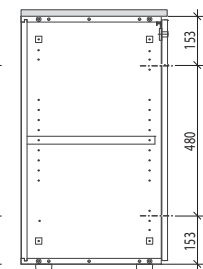

**MONTAGGIO BASSETTE
PER CERNIERE**
 base plates for hinges



SEGUE
 assembling in the following page

**Montaggio ante
Assembling doors**

4



4a Posizionare la parte anteriore della cerniera nella parte anteriore della basetta.
Place the front part of the hinge on the front side of the mounting plate.



4b Far ruotare l'ala.
Rotate the arm of the hinge.

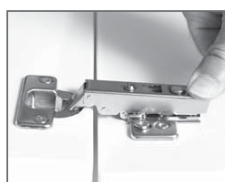



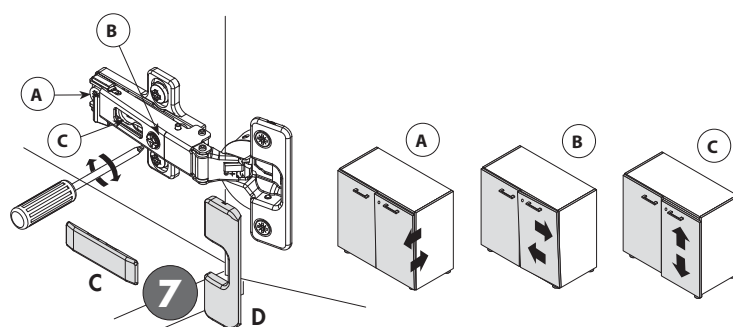

4c Premere la parte posteriore della cerniera per agganciare.
Press down the rear part of the hinge to Click on.

REGOLAZIONE ANTE / adjusting doors

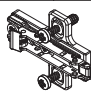
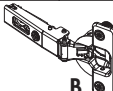
6

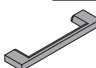

| CODE | COLOUR | CODE | COLOUR | CODE | COLOUR | CODE | COLOUR | CODE | COLOUR | CODE | Ø x L | COLOUR |
|--|----------|---|----------|---|----------|---|----------|---|---------------|---|-----------|---------|
| 507053007 | TITANIO | 507066007 | TITANIO | 507067007 | TITANIO | 507068007 | TITANIO | 508016007 | NERO black | 506910108 | 4MA x 22 | BRUNITA |
|  | A |  | B |  | C |  | D |  | E |  | F4 | |
| | | | | | | | | | | TSPX/PZ | | |

MONTAGGIO BASETTE
PER CERNIERE
base plates for hinges

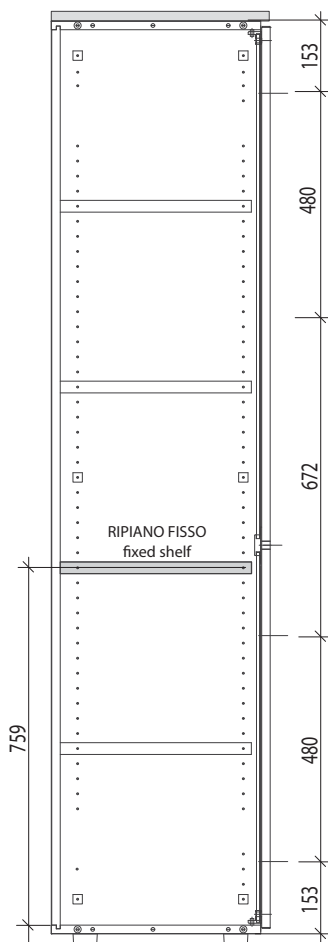

| CODE | COLOUR |
|---|------------------|
| 507140607 | NERO black |
|  | R1 x 2 |

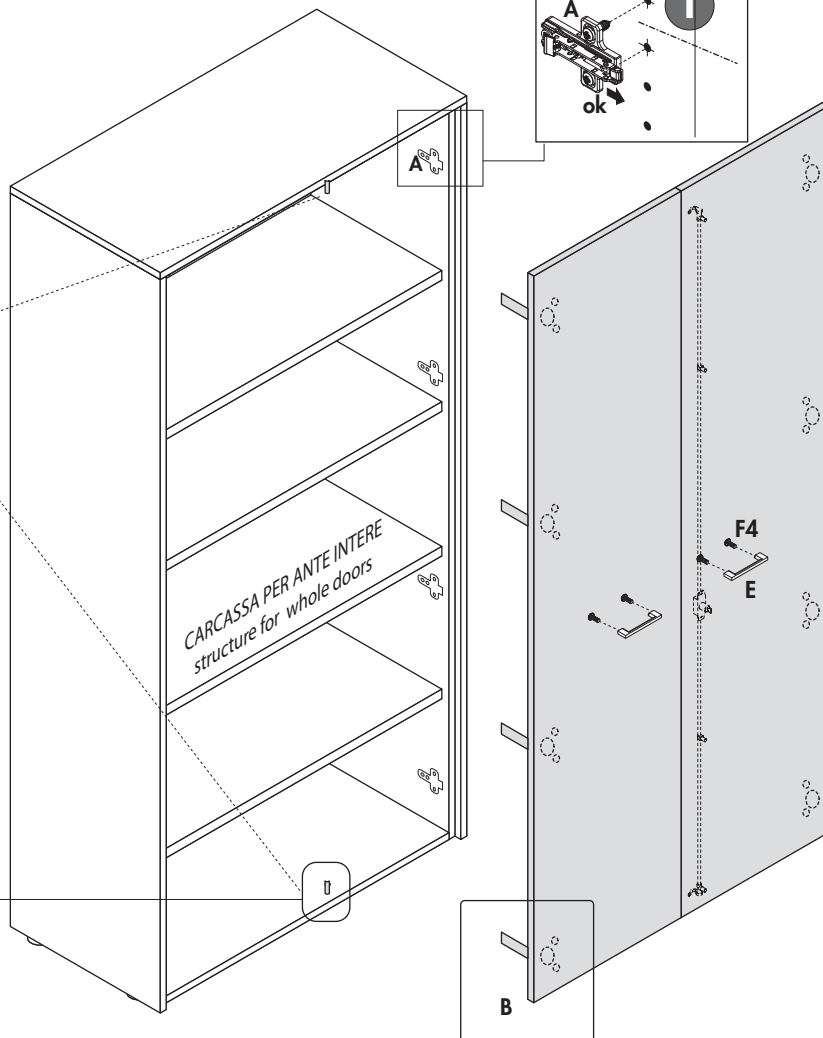
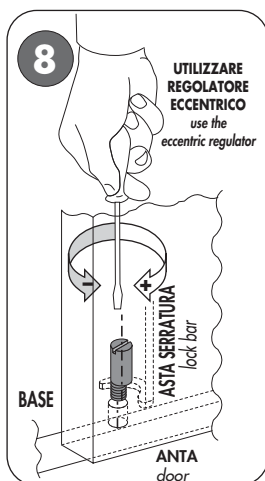

Montaggio ante
Assembling doors

4



4a Posizionare la parte anteriore della cerniera nella parte anteriore della basetta.
Place the front part of the hinge on the front side of the mounting plate.

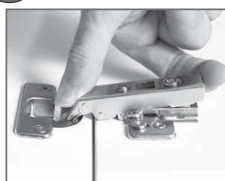

4b Far ruotare l'ala.
Rotate the arm of the hinge.



4c Premere la parte posteriore della cerniera per agganciare.
Press down the rear part of the hinge to Click on.

REGOLAZIONE ANTE / adjusting doors

6

