

1)

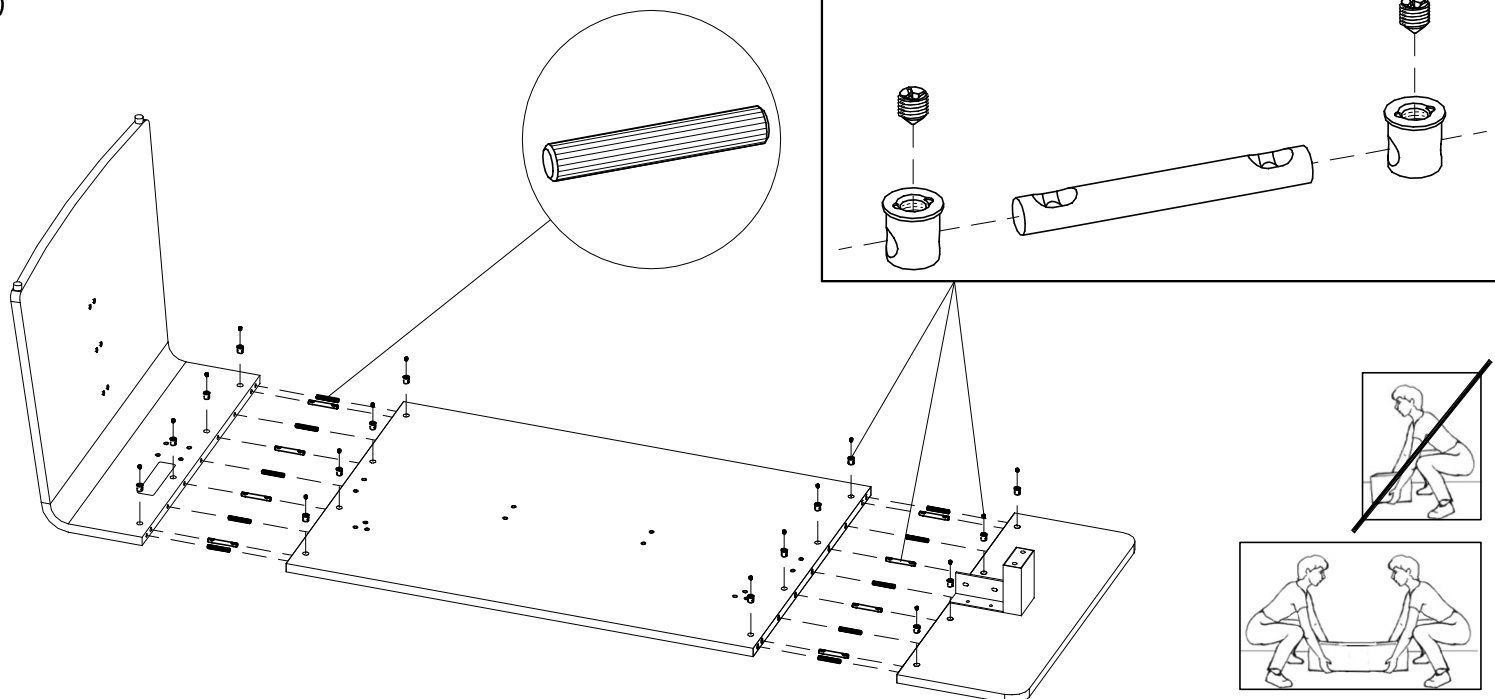

2)

N.3

N.2

Tighten the screws in the following order:
A, B, C, D, E
only after having placed all of them.
Then tighten the 4 bolts with the 4 nuts

N.2

nut with milling

electrified side

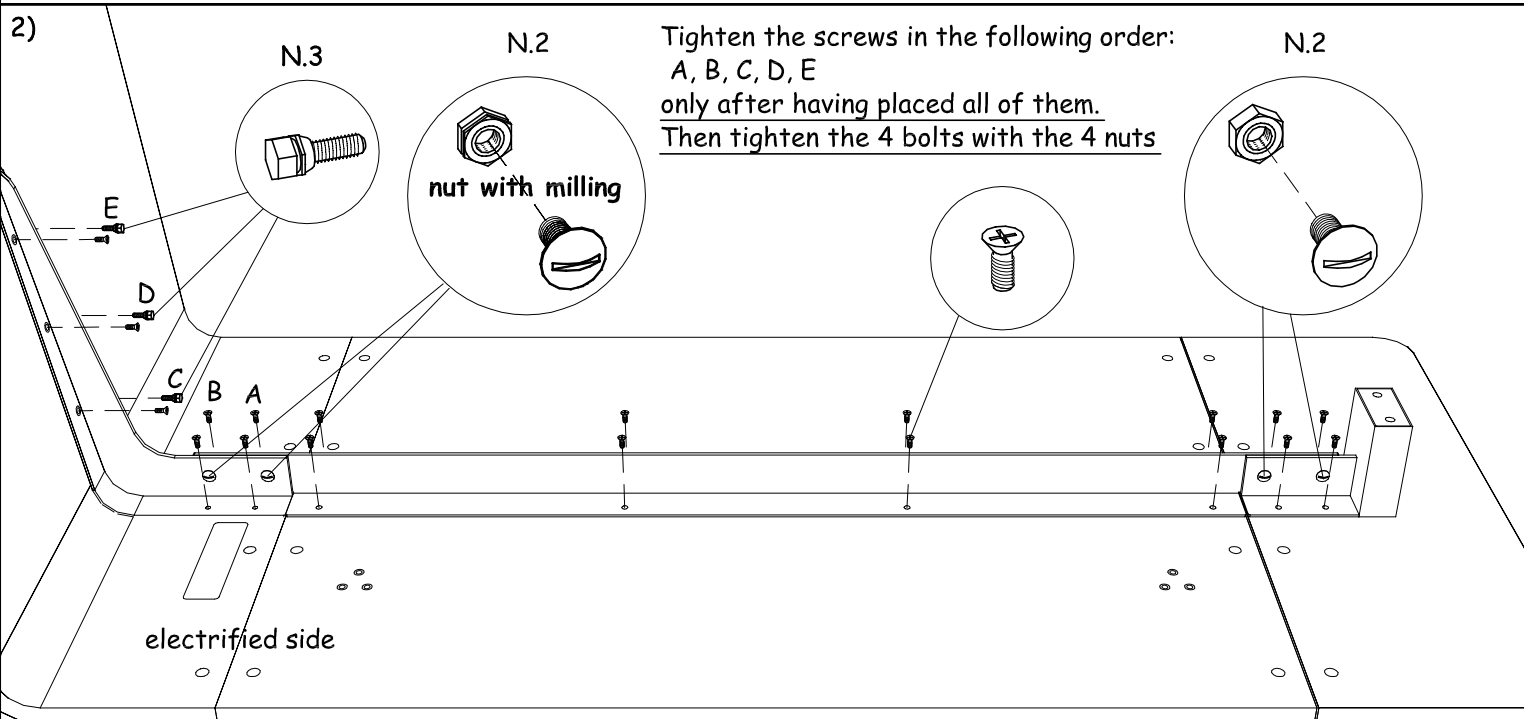

3)

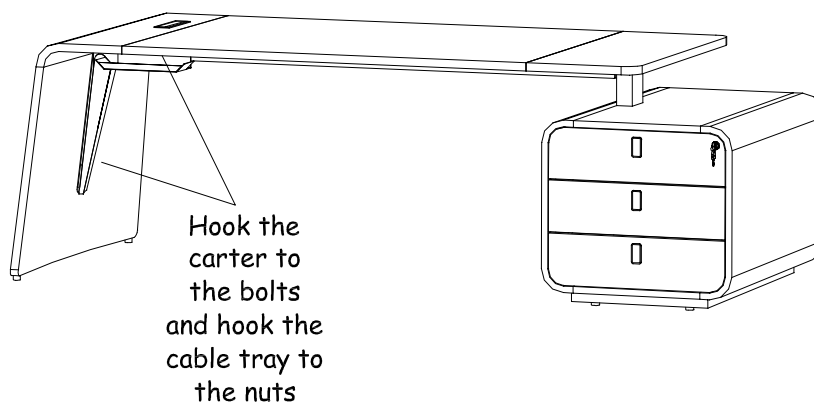
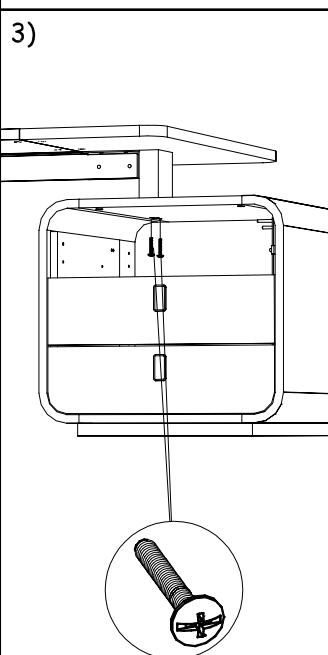

Description:

ASSEMBLY CHART, DESK MODEL "SESTANTE" WITH
SUPPORTING PEDESTAL AND CABLE MANAGEMENT

Code: 95AL01.0002+95BN01.001+95AQ02.0008

Date: 05/03/2010

Executed by:

Canonici Roberto

Approved by:

Canonici Roberto

